



COLONY INDUSTRIAL

PARC 17

1840 S. 7th Avenue
Building 2
Phoenix, Arizona

31,871 SF Square Feet of Rentable Industrial Space



LOCATION:

- Freeway Visibility
- Signage Opportunity
- Secured Yard: 23,000 square feet
- I-17 Interchange Access
- I-17 at 7th Ave. has 240,000 cars per day going northbound/southbound
- 4 miles to Phoenix Sky Harbor International Airport

FACILITY:

Square Feet: 31,871
 Land Acres: 1.96
 Dimensions: 156' x 201'
 Clear Height: 28'
 Parking: 2.6:1,000
 DH Doors: (3) 9' x 10'
 DI Doors: (1) 12' x 14'
 Truck Court Depth: 120' x 10"
 Typical Column Spacing: 50' x 56', 48' x 50'
 Upgraded Power: Amps
 ESFR



Lee & Associates

Stein J. Koss, SIOR | Principal
 Lee & Associates Arizona
 3200 E. Camelback Road, Suite 100
 Phoenix, Arizona 85018
 Direct: 602.912.3520
 Email: skoss@leearizona.com

Lee & Associates

Tom Louer, SIOR | Principal
 Lee & Associates Arizona
 3200 E. Camelback Road, Suite 100
 Phoenix, Arizona 85018
 Direct: 602.954.3779
 Email: tlouer@leearizona.com

Colony Industrial

Blake Sullivan
 Colony Northstar, Inc.
 13727 Noel Road, Suite 750
 Dallas, Texas 75240
 Direct: 972.893.7000
 Email: bsullivan@clns.com





COLONY INDUSTRIAL

PARC 17

1840 S. 7th Avenue
Building 2
Phoenix, Arizona

31,871 SF Square Feet of Rentable Industrial Space

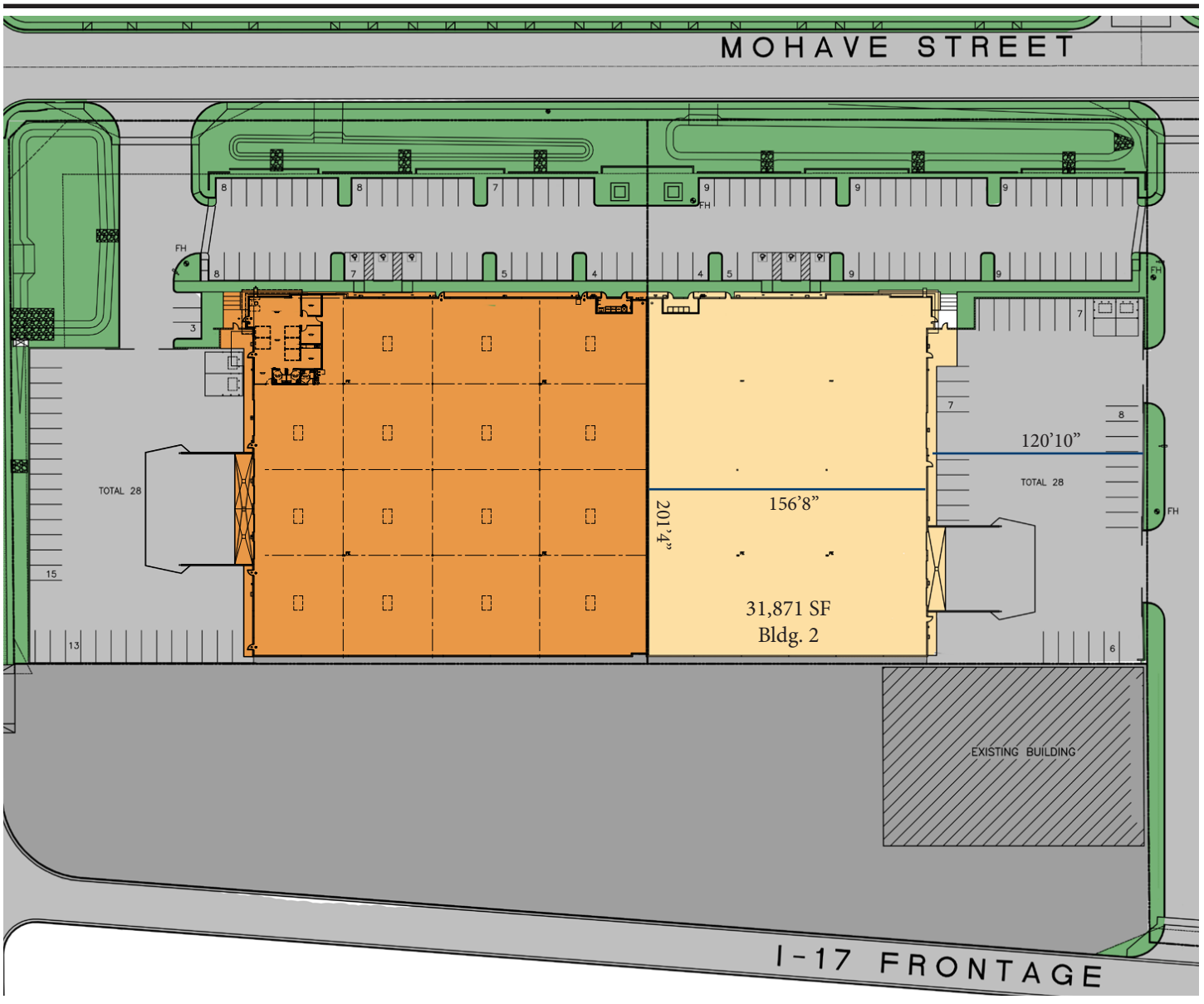

Lee & Associates

Stein J. Koss, SIOR | Principal
Lee & Associates Arizona
3200 E. Camelback Road, Suite 100
Phoenix, Arizona 85018
Direct: 602.912.3520
Email: skoss@leearizona.com

Lee & Associates

Tom Louer, SIOR | Principal
Lee & Associates Arizona
3200 E. Camelback Road, Suite 100
Phoenix, Arizona 85018
Direct: 602.954.3779
Email: tlouer@leearizona.com

Colony Industrial

Blake Sullivan
Colony Northstar, Inc.
13727 Noel Road, Suite 750
Dallas, Texas 75240
Direct: 972.893.7000
Email: bsullivan@clns.com

